



Booklet Maker BM60/61

Parts Manual

Part No. 60242

TABLE OF CONTENTS

1. USER INFORMATION

2. PARTS LIST

2.1 BM 60/COMMON PARTS	5
2.1.1 OUTER FRONT VIEW.....	5
2.1.2 OUTER REAR VIEW.....	6
2.1.3 INSIDE TOP COVER.....	7
2.1.4 INNER TOP VIEW.....	8
2.1.5 INNER TOP VIEW, CONTINUED.....	9
2.1.6 STAPLER HEAD ASSEMBLY.....	10
2.1.7 CRANK WHEEL ASSEMBLY.....	11
2.1.8 STAPLER LINKAGE.....	12
2.1.9 STAPLE STOP CARRIAGE.....	13
2.1.10 FOLD KNIFE.....	14
2.1.11 FOLD ROLLERS.....	15
2.1.12 TRANSMISSION.....	16
2.1.13 CONVEYOR BELT STACKER.....	17
2.1.14 DELIVERY TRAY.....	18
2.1.15 ELECTRICAL COMPONENTS.....	19
2.1.16 PCB AND FRONT PANEL.....	20
2.1.17 BASE.....	21
2.2 BM 61 PARTS	22
2.2.1 INNER TOP VIEW, BM 61.....	22
2.2.2 INFEED VIEW, BM 61.....	23
2.2.3 INFEED IDLER ARM, BM 61.....	24
2.2.4 REAR JOGGER ASSEMBLY, BM 61.....	25
2.2.5 JOGGER LINKAGE, BM 61.....	26
2.2.6 STAPLER STOP, BM 61.....	27

1. USER INFORMATION

This parts list is divided into one BM 60 and one BM 61 section.

The BM 60 section contains both common parts and parts only existing in the BM 60.

The unique BM 60 parts are indicated by "BM 60" in the "Note"- column.

The unique BM 61 parts are shown in section 2.

The quantity indicated in the "Qty"-column is the total number of this part in the machine.

2. PARTS LIST

2.1 BM 60/COMMON PARTS

2.1.1 OUTER FRONT VIEW

Item	Part no	Qty.	Description	Note
1.	61186	1	Top Cover	
2.	60592	1	Hand wheel	
3.	60735	1	Cover, upper front	BM 60 only
4.	61203	1	Cover, right	
5.	30603	1	Fuse 4 A	
	47076	1	Fuse label	
6.	601104	1	Receptacle	
7.	607029	4	Stud	
8.	601103	1	Cover, Lower infeed	
9.	87156	1	Power cord	230 V
	87157	1	Power cord	115 V
	88530	1	Power cord	UK

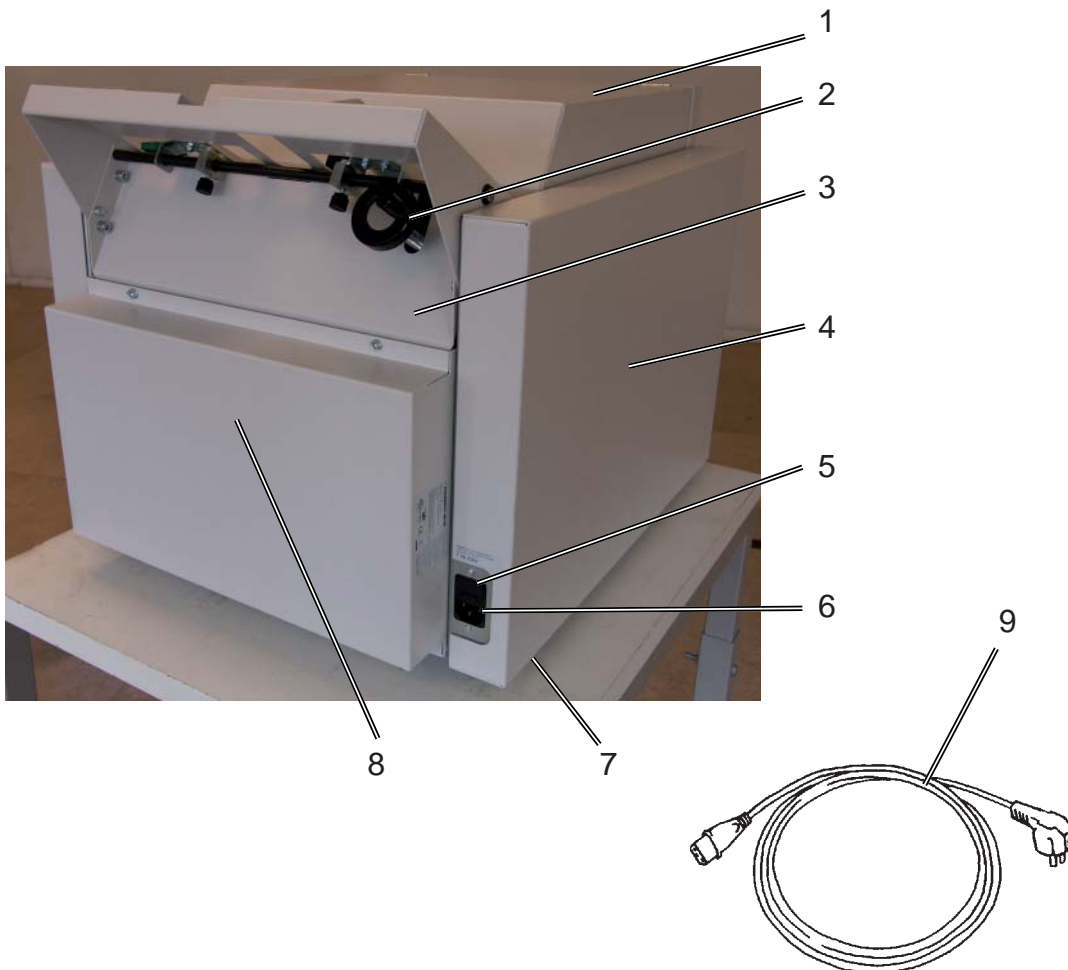

2.1.2 OUTER REAR VIEW

Item	Part no.	Qty.	Description	Note
1.	61183	1	Paper guide, outfeed	
2.	87806	2	Paper guide, folding	
3.	61098	1	Paper path, lower	
4.	96017	1	Outlet	
5.	60769	1	Label, "Do not lift..."	
6.	60618	1	Fold stop	
7.	60617	1	Frame, fold stop	
8.	60620	1	Spring	
9.	607029	4	Stud	
10.	60619	2	Bar, fold stop	
11.	61185	1	Cover, rear	
12.	611005	1	Cover, left	
13.	61208	2/4	Bracket for stacker	BM 60, Océ/Other models
14.	86173	2	Hinge	

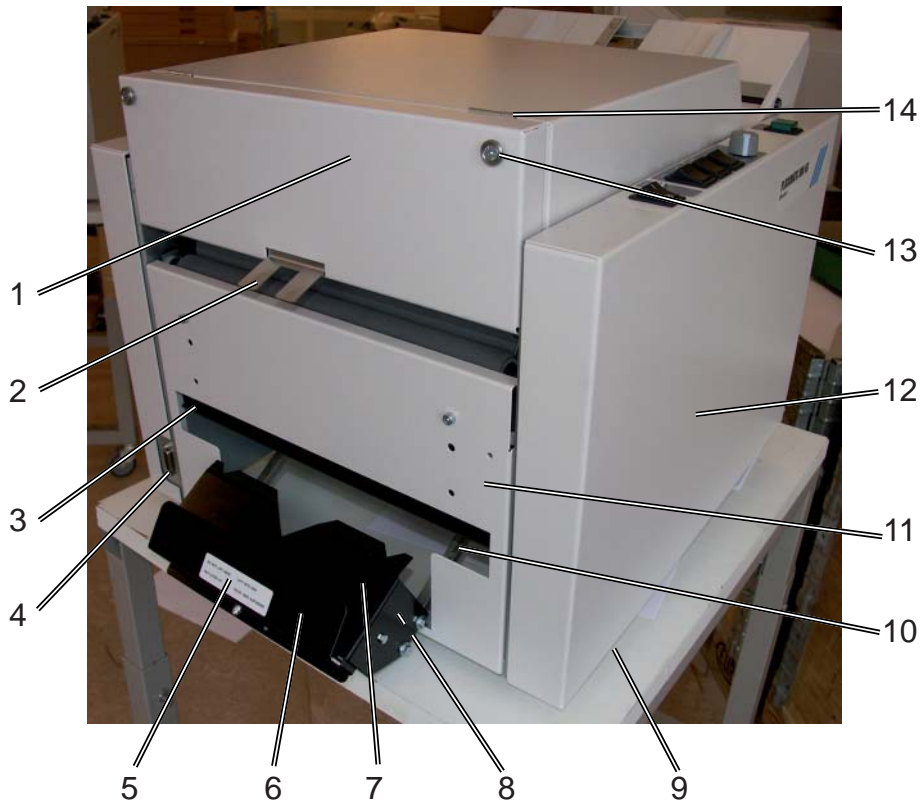

2.1.3 INSIDE TOP COVER

Item	Part no.	Qty.	Description	Note
1.	60720	1	Clamp	
2.	88702	1	Label, modification	
3.	60774	1	Key, allen 2 mm	
	60562	3	Grommet	
4.	61183	1	Paper guide, outfeed	
5.	60718	1	Safety bracket	
6.	60741	1	Bar, top cover	
7.	607030	2	Stop pin, for corner/edge stapling	

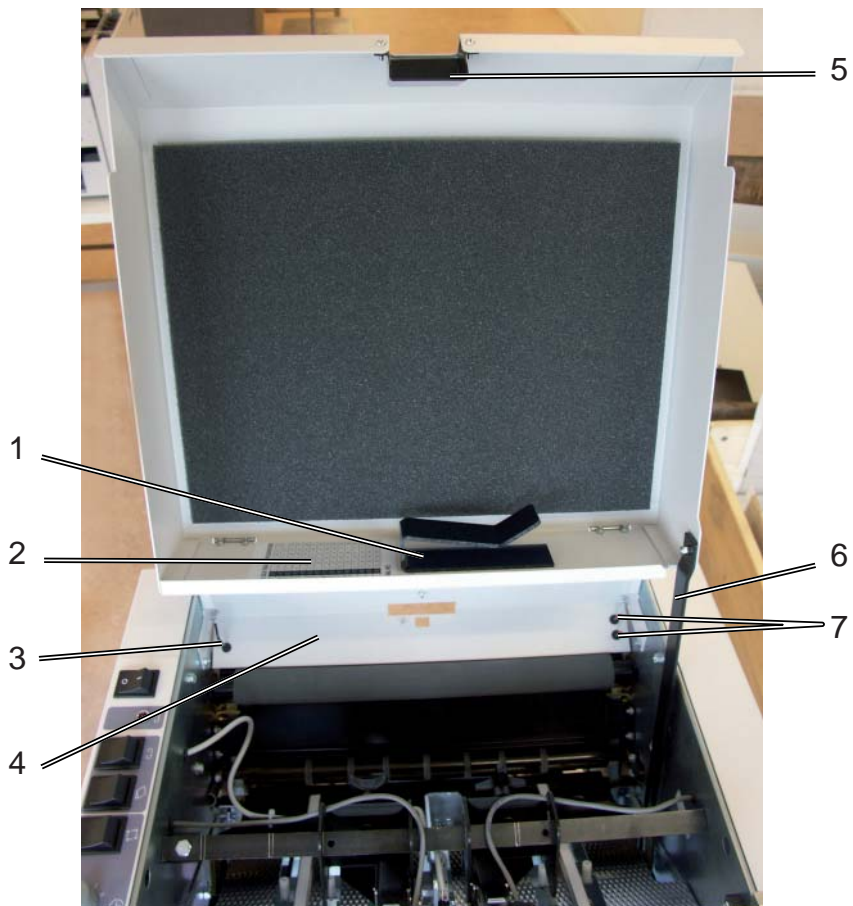

2.1.4 INNER TOP VIEW

Item	Part no.	Qty.	Description	Note
1.	60682	1	Paper guide, left	BM 60 only
2.	60671	2	Guide, paper guide	BM 60 only
	60673	2	Holder, paper guide	BM 60 only
	60674	2	Screw, guider	BM 60 only
3.	60747	1	Shaft, Paper guide	BM 60 only
4.	60684	1	Scale, length adjustment	
5.	60672	1	Paper guide, right	BM 60 only
6.	600126	1	Paper path, upper	Incl. 60684, BM 60 only
7.	60763	2	Countersunk washer	
	Not spared	2	Washer	
8.	60750	1	Bar, Upper stapler	
9.	60512	8	Bearing, connecting rod	Brass
	99011	8	Screw, M5x20	Brass

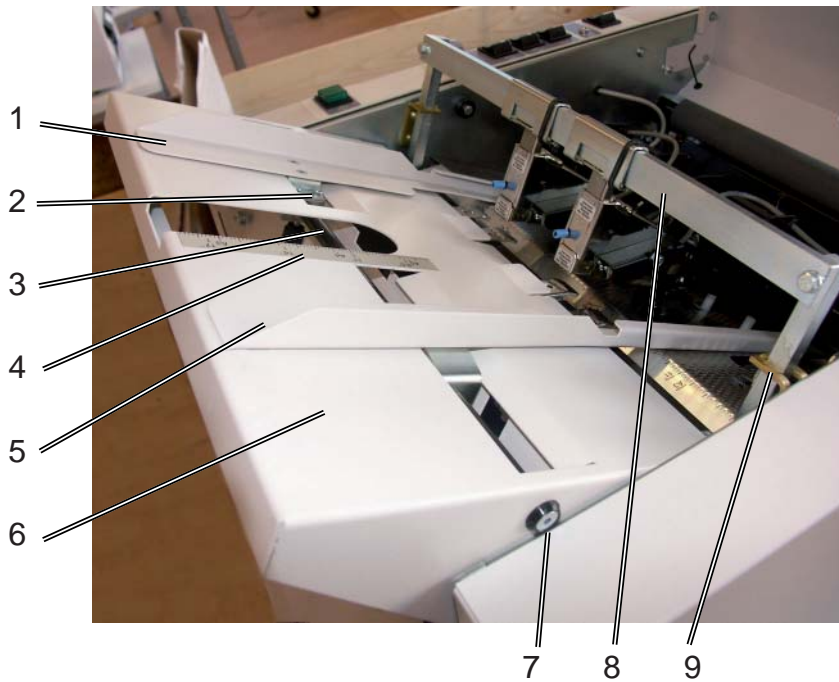

2.1.5 INNER TOP VIEW, CONTINUED

1.	60558	1	Label, single/double switch	
2.	60560	1	Indication switch single/double	SW 13
3.	60546	1	Holder, Stapler head	Right
4.	60545	1	Holder, Stapler head	Left
5.	61199	1	Bracket, Idler roller	
6.	60551	2	Knob	
7.	60579	1	Bracket, Idler bracket	
8.	60154	1	Stapler girder	
9.	61207	1	Paper path, middle	

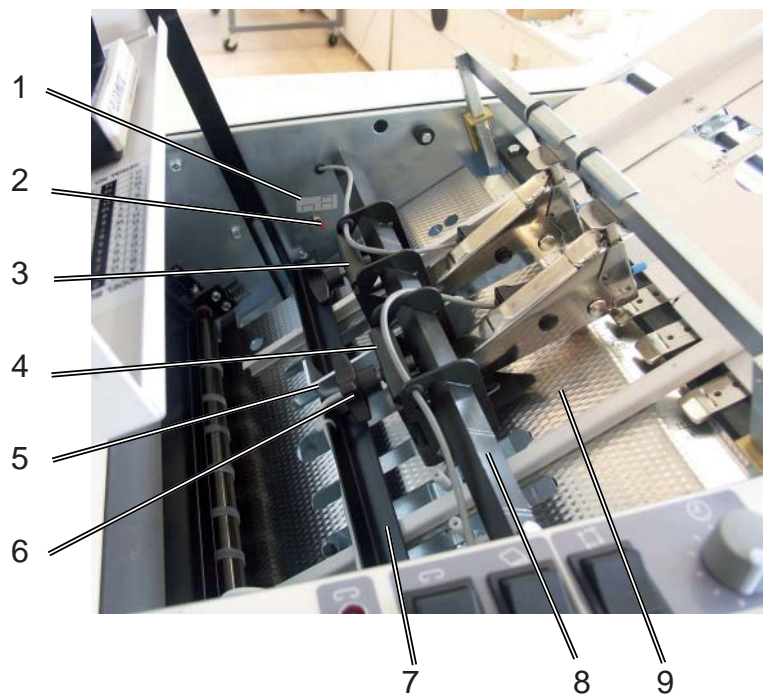

2.1.6 STAPLER HEAD ASSEMBLY

Item	Part no.	Qty.	Description	Note
1.	60732	2	Lifting clamp	
2.	60765	2	O-ring	
3.	607001	1	Stapler head	Incl. 607049
	60553	2	Stapler head	
4.	607049	2	Stapler detection assy.	SW 11(R), SW 12(L)
	60563	2	Ball, detection	Incl. in 607049
	60554	2	Cover, switch	Incl. in 607049
	60557	2	Insulator, switch	Incl. in 607049
5.	60571	1	Bar, anvil	
6.	60572	5	Anvil	
7.	60714	1	Scale	BM 60 only
8.	60549	2	Thrust socket	
9.	60546	1	Holder, Stapler head	Right
	60545	1	Holder, Stapler head	Left
10.	610214	1	Harness, start sensor	
11.	96997	1	Sensor	SW 10
12.	60593	1	Idler roller	

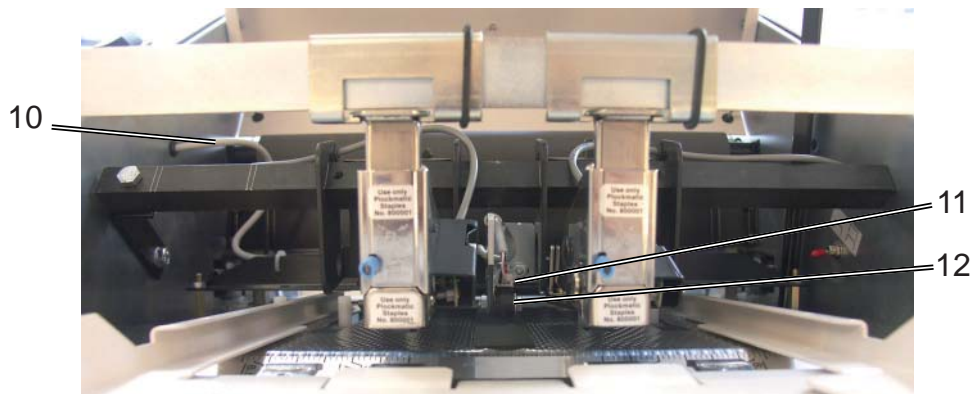

2.1.7 CRANK WHEEL ASSEMBLY

Item	Part no.	Qty.	Description	Note
1.	60592	1	Hand wheel	
2.	Not spared	2	Nut M10 mm	
3.	60591	1	Guide shaft	
4.	60895	2	Spring	BM 60 only

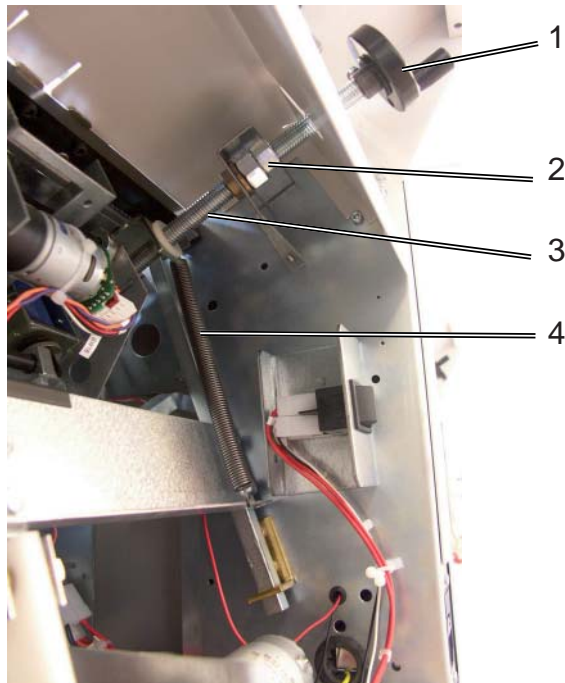

2.1.8 STAPLER LINKAGE

1.	60895	2	Spring	BM 60 only
2.	60748	2	Pull rod, stapler	
3.	60512	8	Bearing, connecting rod	Brass
	99011	8	Screw, M5x20	Brass
4.	60738	1	Bracket, connecting rod	
5.	60514	1	Edge strip	
6.	60739	1	Bracket, crank shaft	
7.	60702	1	Crank shaft	
8.	606003	2	Crank assembly	
9.	60701	1	Bracket, stapling support	
	60508	1	Flange bearing	
10.	61197	1	Bracket, Stapler Motor	
11.	60705	1	Edge strip	
12.	610209	1	Harness, Power Supply	

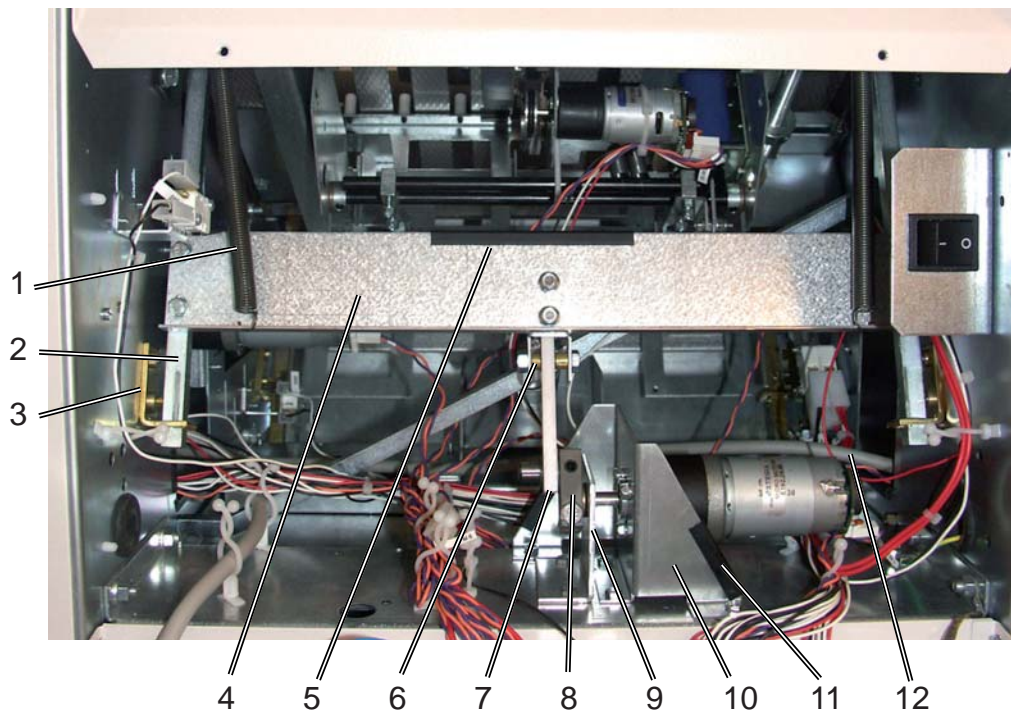

2.1.9 STAPLE STOP CARRIAGE

Item	Part no.	Qty.	Description	Note
1.	60852	2	Collar	
2.	60589	1	Shaft, upper for link	
3.	61204	1	Pulley	
4.	770150	1	Pulley assy.	
5.	61211	1	O-ring	
6.	604007	1	Staple stop assembly	BM 60 only
7.	60578	1	Link	
8.	60587	1	Shaft, lower for link	
9.	76112	1	Spacer bar	
10.	61198	1	Sledge	
11.	75016	1	Cradle	
12.	531004	1	Solenoid	
13.	90170	2	Spring	
14.	781022	1	Motor	
15.	76128	1	Link, swing	

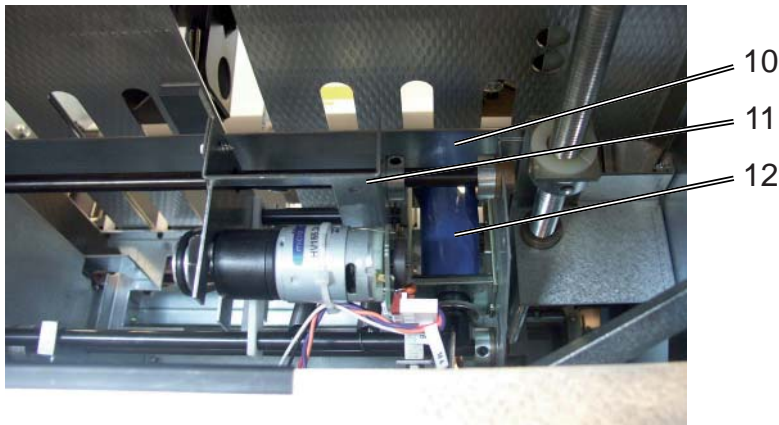
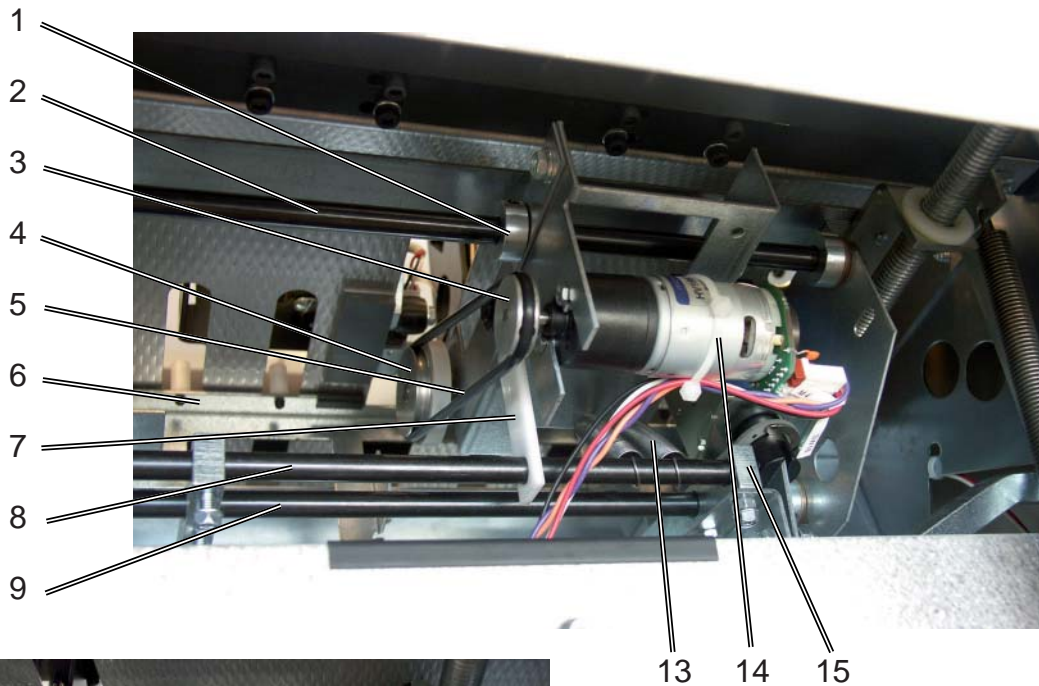

2.1.10 FOLD KNIFE

Item	Part no.	Qty.	Description	Note
1.	60541	2	Guide, fold knife	
2.	60105	1	Fold Knife	
3.	60505	1	Crank shaft	
4.	60508	1	Bushing	
	60507	1	Pin	
	60510	1	Retaining ring	
5.	60542	1	Bracket, crank shaft assy	
6.	60509	1	Knife support	
7.	602017	1	Switch, Knife home pos.	SW 8
8.	60115	1	Guide plate	
9.	60539	1	Bracket, fold knife	
10.	606003	1	Crank assembly	
	60503	1	Support, knife motor	
	60529	1	Flanged bushing	
11.	61195	1	Bracket, fold knife motor	

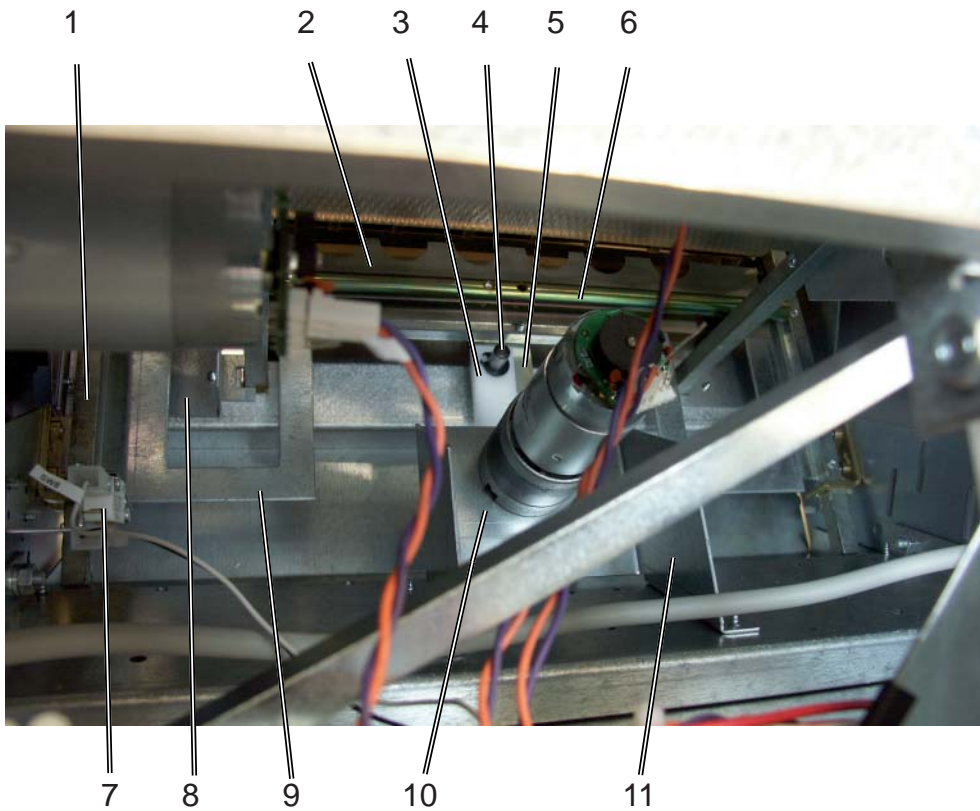

2.1.11 FOLD ROLLERS

Item	Part no.	Qty.	Description	Note
1.	60740	2	Guide plate	
2.	60528	1	Guide bracket	Rear right
3.	Not spared	1	Nut M10	Self locking
4.	60733	1	Guide supporter	
5.	600125	2	Fold roller step 2	
6.	75149	2	Flanged bushing	
7.	60744	2	Stop for back	
8.	60508	4	Flanged bushing	
9.	60541	2	Guide bar, knife	
10.	603049	2	Fold roller step 1	
11.	60681	7	Rubber ring	



2.1.12 TRANSMISSION

Item	Part no.	Qty.	Description	Note
1.	60742	2	Nut plate	
2.	60623	2	Spring bracket	
3.	603045	1	Roller assembly, chain str.	
4.	60753	1	Spring	
5.	600105	1	Chain tensioner	
6.	60707	2	Terminal	
7.	60625	4	Spring	
8.	603012	1	Roller bracket, flexible	
9.	10543	2	Sprocket	
10.	603043	1	Roller assembly, Bearing	
11.	600119	2	Roller bracket, fixed	
12.	60760	1	Chain	
13.	603044	1	Roller assembly, Frame	
14.	88826	2	Sprocket	
15.	60621	4	Spring holder	
	60622	4	Spacer bracket	
16.	60752	4	Spring	
17.	61196	2	Bracket, transmission motor	
18.	60534	1	Sprocket	

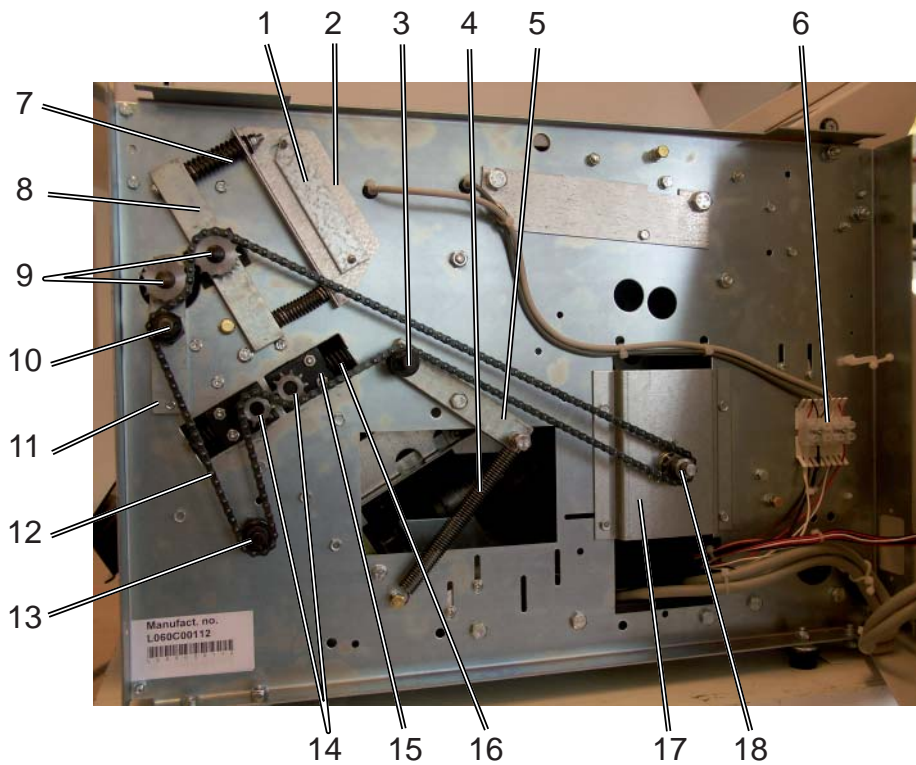

2.1.13 CONVEYOR BELT STACKER

Item	Part no.	Qty.	Description	Note
1.	75557	2	Conveyor belt	
2.	770230	1	Harness, stacker motor	
3.	601105	1	Stacker motor	
4.	76231	4	Gear	



1

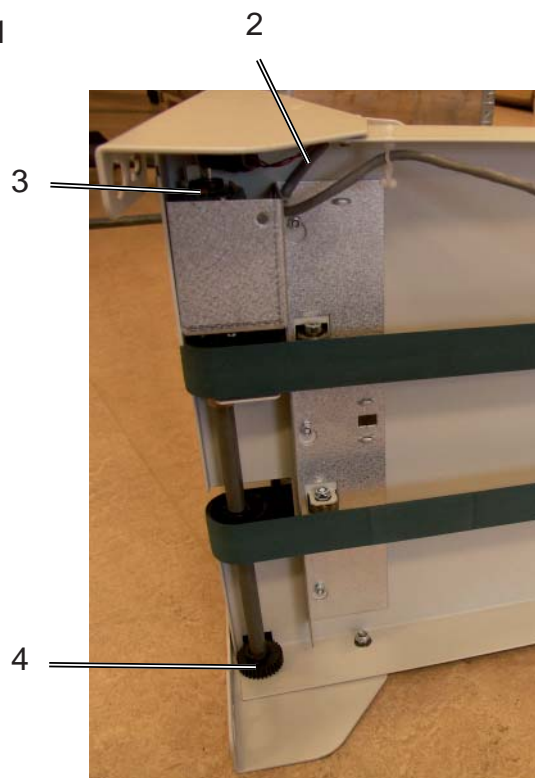

2

3

4

2.1.14 DELIVERY TRAY

Item	Part no.	Qty.	Description	Note
1.	60979	1	Tray	
2.	60514	1	Edge strip	
3.	60684	1	Scale	
4.	60843	1	Stud	
	60844	1	Knob	
5.	60841	1	Slide path	
6.	61208	2	Bracket for stacker	

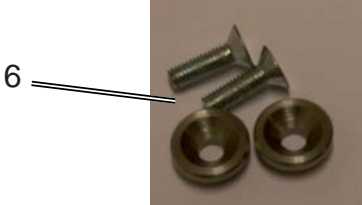
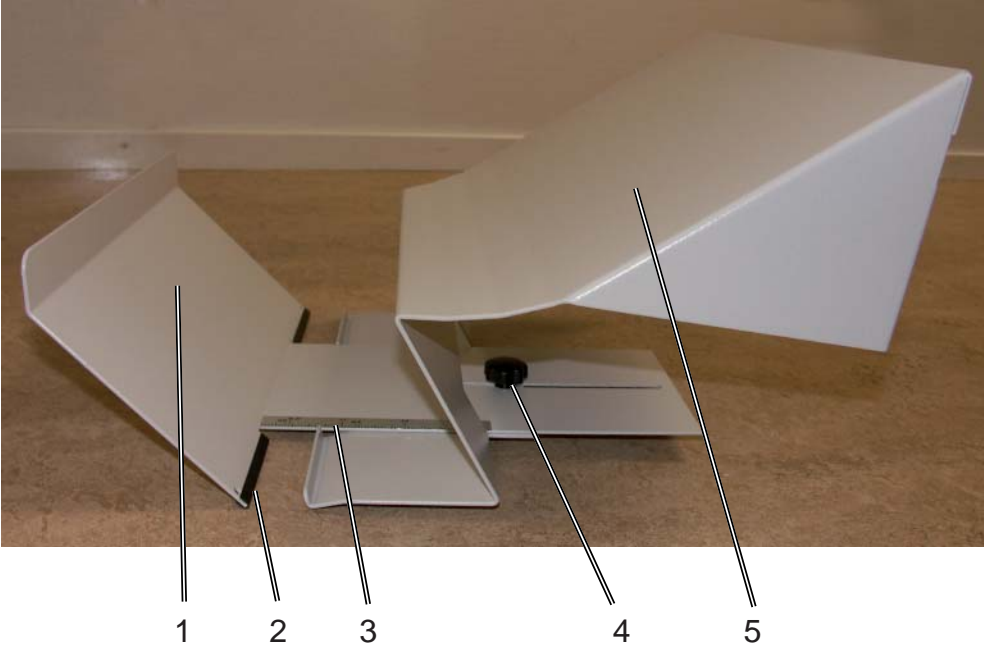

2.1.15 ELECTRICAL COMPONENTS

Item	Part no.	Qty.	Description	Note
1.	602017	1	Switch, stapling home pos.	SW 7
2.	531004	1	Solenoid	S 1
3.	781022	1	Motor, Feed	MOT 4
4.	80652	1	Switch, Safety interlock	SW 6
	60517	1	Arm, switch	
5.	87083	1	Switch, Safety interlock	SW 14
	60517	1	Arm, switch	
6.	601101	3	Motor, DC	MOT 1, MOT 2, MOT 3
7.	60705	1	Edge strip	

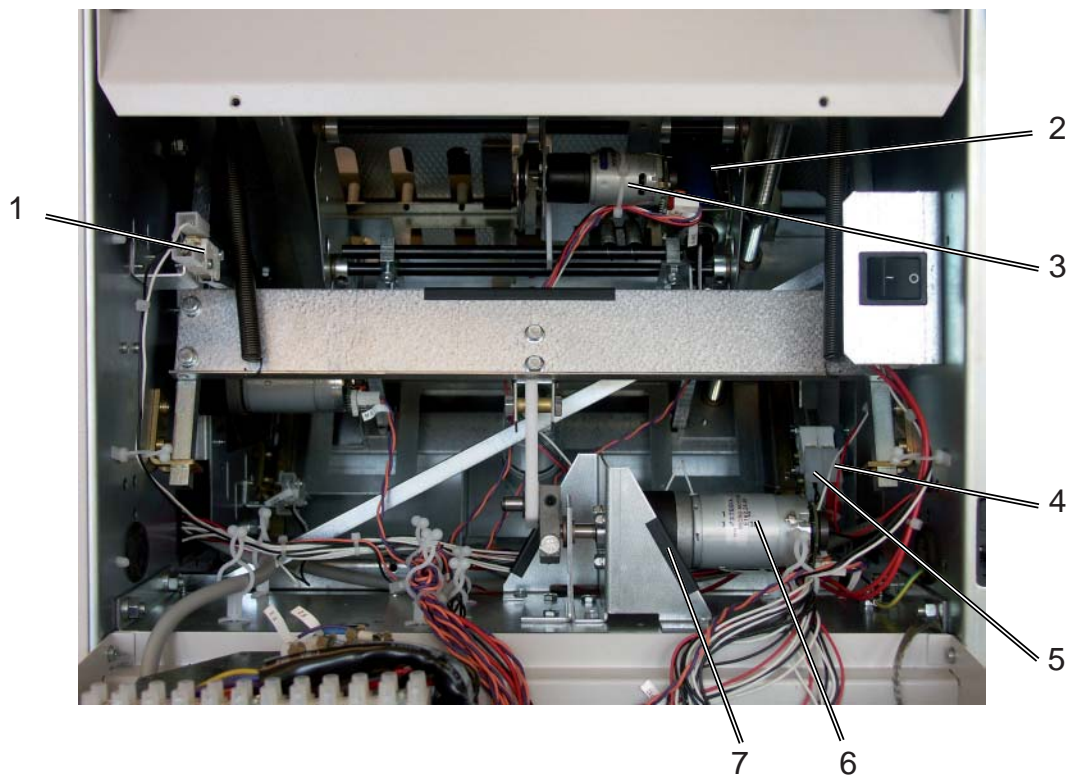

2.1.16 PCB AND FRONT PANEL

Item	Part no.	Qty.	Description	Note
1.	60976	1	Power switch	SW 1, all models
2.	88524	1/2	LED socket	BM 60/BM 61
	12852	1/2	LED	BM 60/BM 61
3.	60690	3	Panel switch	SW 2, SW 3, SW 4
4.	60693	1	Potentiometer	
	601102	1	Knob for time setting	
5.	60217	1	Front panel	Océ
	60218	1	Front panel	BM 60
	61194	1	Front panel	BM 61
6.	60994	1	Manual start switch	SW 5
7.	18446	1	Transformer	
	61187	1	Bracket, transformer	
8.	96951	1	Capacitor	
9.	610211	1	Harness, Sensors	
10.	61189	1	Mounting plate electric	
11.	171020	1	PCB MD6DC	
	53199	1	PCB Support 12.7 mm	
	53200	1	PCB Support 10.7 mm	
	56698	1	PCB Support 9.5 mm	
12.	96613	1	Rectifier	
13.	610210	1	Harness, Motors	

NOTE: Make sure to download latest software if replacing PCB.
 To download software, download cable part no. 770010 is required.

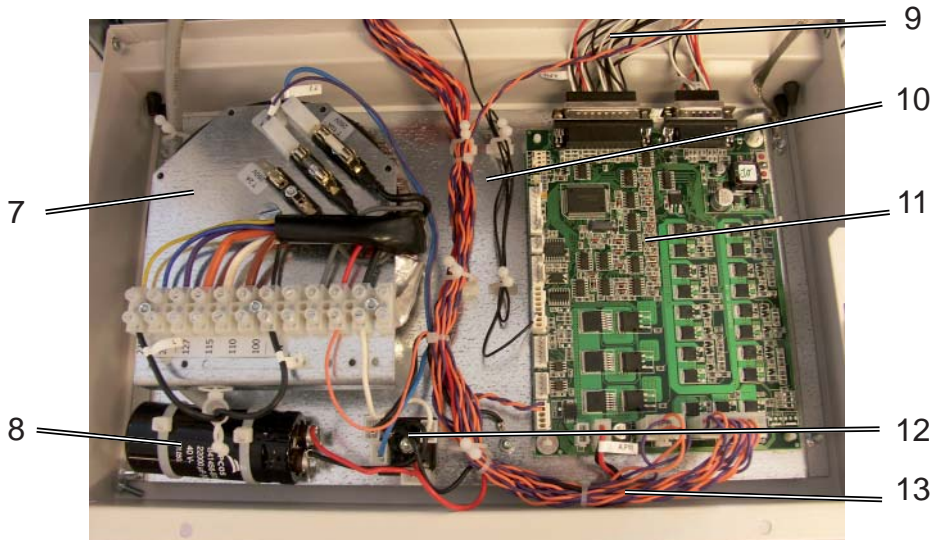
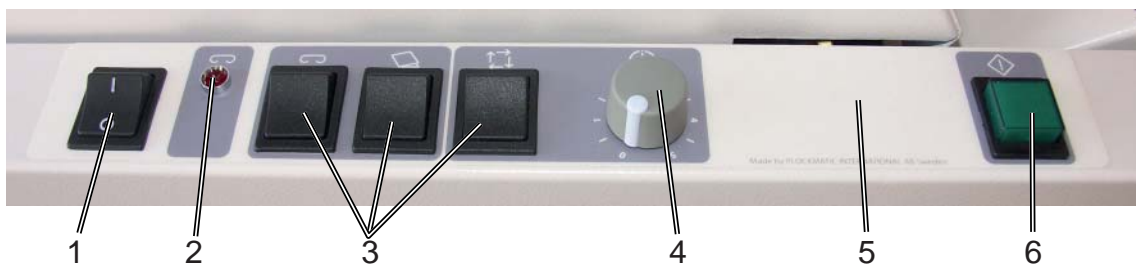

2.1.17 BASE

Item	Part no.	Qty.	Description	Note
1.	88465	4	Castor	



1

2.2 BM 61 PARTS

2.2.1 INNER TOP VIEW, BM 61

Item	Part no.	Qty.	Description	Note
1.	61040	1	Shaft, manual movement	
2.	611012	1	Lock assembly, side guide L	Incl. 60751, 61005
	60751	1	Spring	
3.	61051	1	Spring	
4.	61049	1	Spring	
5.	61148	1	Scale, width adjustment	
6.	61005	4	Label, green dot	
7.	611011	1	Lock assembly, side jogger R	Incl. 60751
	60751	1	Spring	
8.	61039	1	Shaft, jogger movement	
9.	88243	2	Flange bushing	
	88236	1	Retaining ring	
10.	61007	2	Label, green strip	
11.	611013	1	Side guide assembly, left	
12.	610139	1	Docking plate	Inch format
	610140	1	Docking plate	Metric format
13.	61071	1	Paper path, infeed	
14.	61147	1	Scale, length adjustment	
15.	610142	1	Side jogger assembly, right	
16.	61006	1	Label, green arrow	

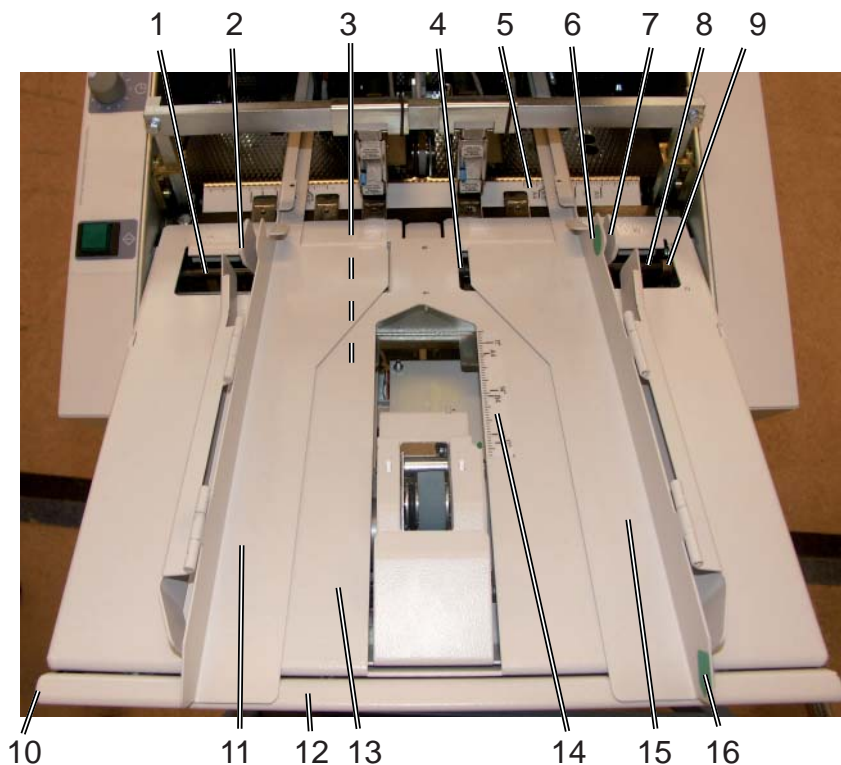

2.2.2 INFEED VIEW, BM 61

Item	Part no.	Qty.	Description	Note
1.	61007	2	Label, green line	
2.	60551	3	Knob	
3.	61221-26	1	Cover, upper front	
4.	61005	4	Label, green dot	
5.	90169	1	Spring	
6.	610139	1	Docking plate assembly	Metric format, incl. 90169, 61007
	610140	1	Docking plate assembly	Inch format, incl. 90169, 61007

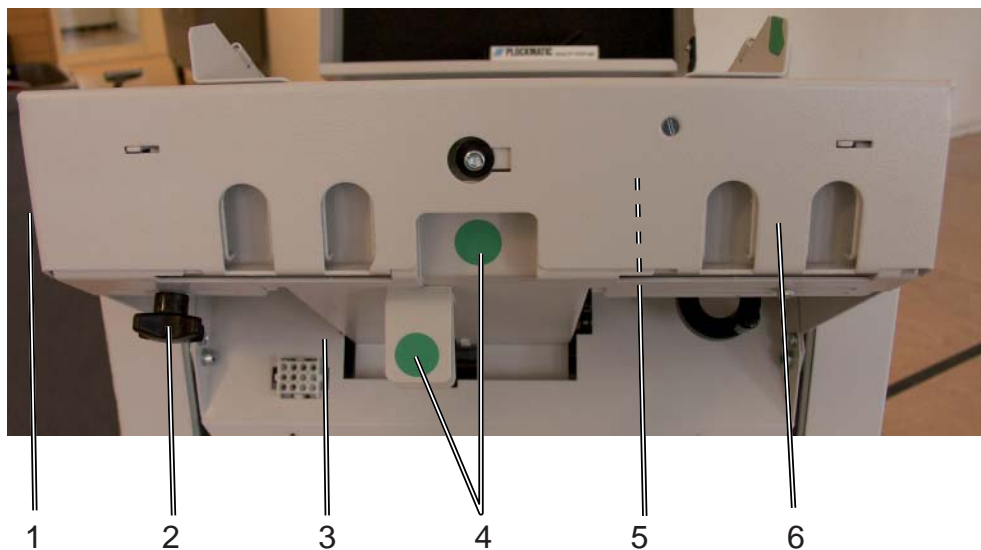

2.2.3 INFEED IDLER ARM, BM 61

Item	Part no.	Qty.	Description	Note
1.	40514	1	Spacer, plastic	
2.	611009	1	Idler wheel	
3.	611008	1	Infeed idler arm	Incl. 40514, 61007
4.	61007	1	Label, green strip	
5.	61003	1	Scale, length adjustment	
6.	61033	1	Idler bracket	
7.	Not spared	2	Winged nut M4 mm	
	610123	1	Infeed Idler arm kit	Incl. items 1-7

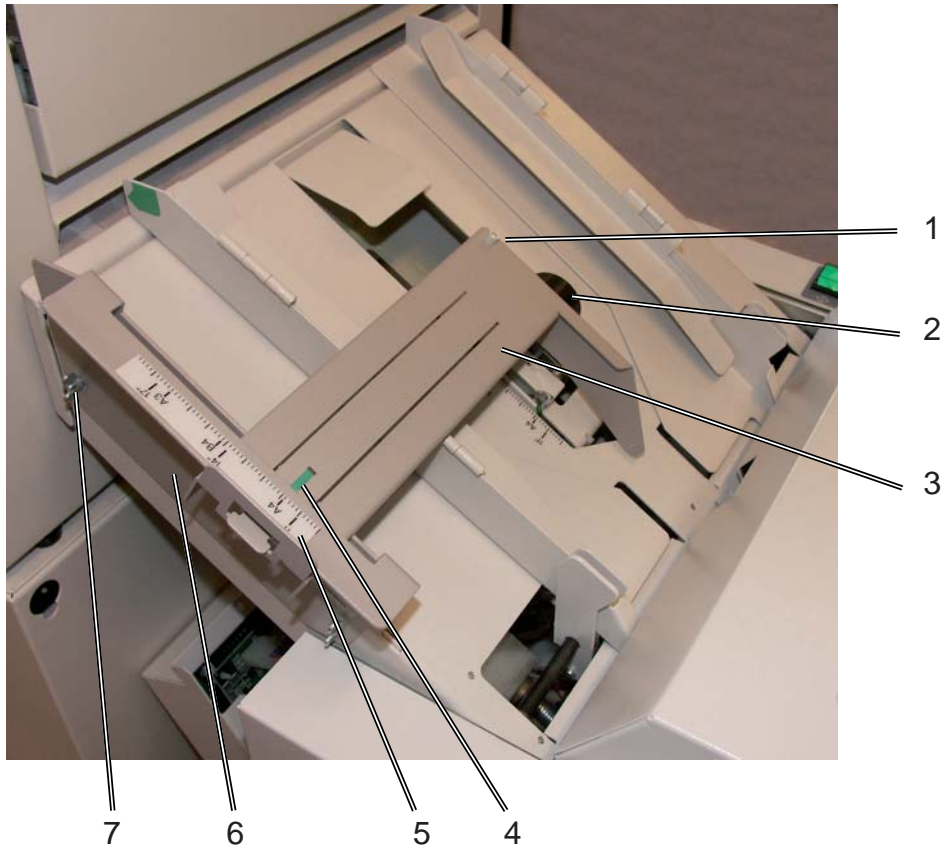

2.2.4 REAR JOGGER ASSEMBLY, BM 61

Item	Part no.	Qty.	Description	Note
1.	60634	1	Cable hanger	
2.	61079	1	Frame, rear jogger	
3.	61077	1	Jogger	
4.	61084	1	Spacer, Index	
5.	61080	1	Guide plate	
6.	61026	1	Index	
7.	61082	3	Spacer, Guide plate	
8.	611001	1	Feed wheel	Incl. 61124
	61124	1	Friction tire	
9.	610156	1	Rear jogger motor	
10.	61053	2	O-ring	
11.	611002	1	Clutch wheel	
12.	61078	1	Bracket, Rear jogger	
13.	88998	1	Spring	
14.	61023	1	Positioning handle	
15.	61024	1	Positioning lock	

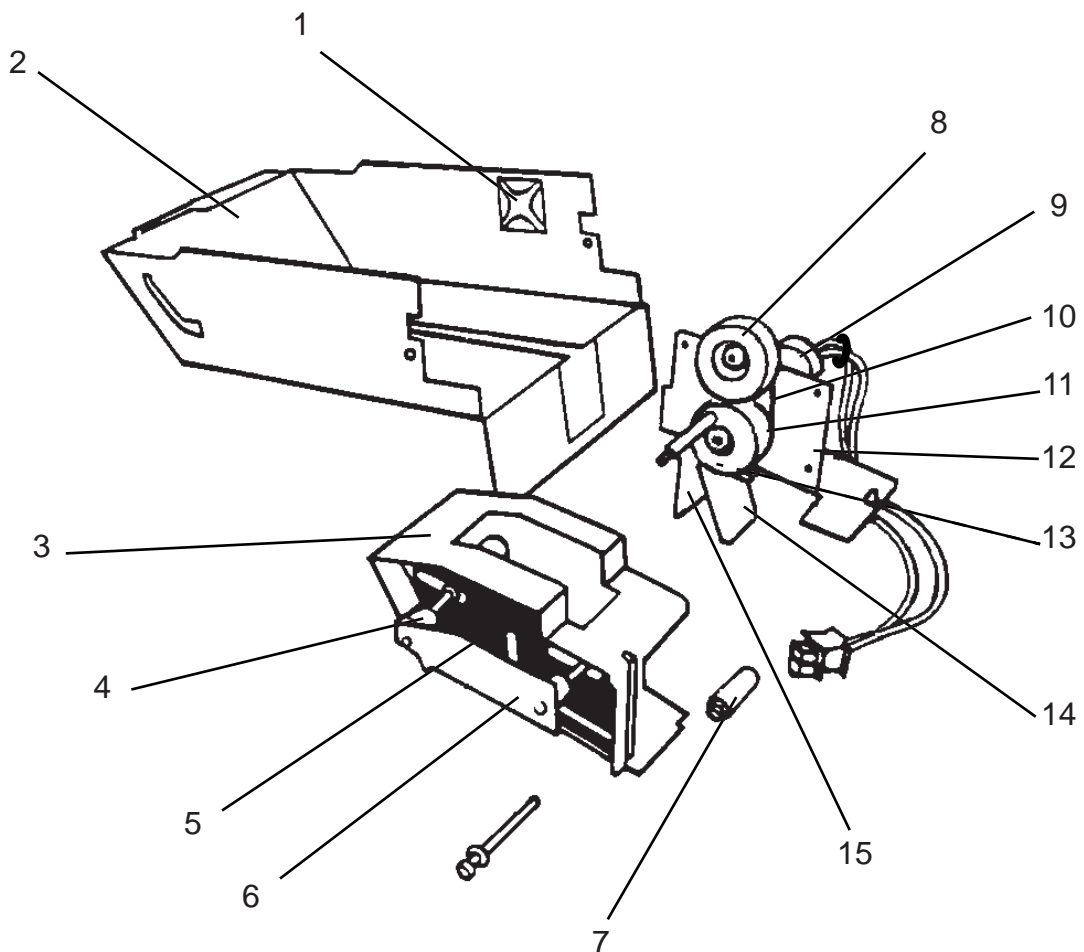

2.2.5 JOGGER LINKAGE, BM 61

Item	Part no.	Qty.	Description	Note
1.	61166	2	Spacer, guide shaft	
2.	61050	1	Spring	
3.	61052	2	Spring	
4.	61188	2	Bracket, jogger linkage	
5.	610141	1	Jogger linkage assembly	Incl. 61188, washers, screws, spacers, nuts

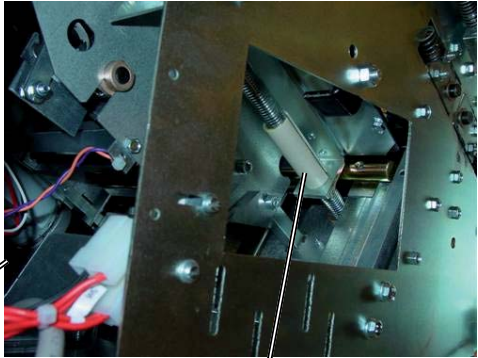
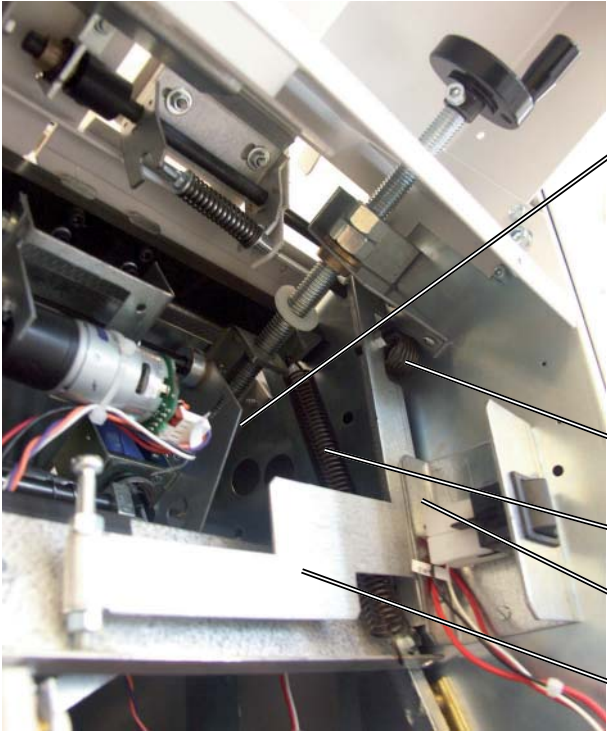

1

2

3

4

5

2.2.6 STAPLER STOP, BM 61

Item	Part no.	Qty.	Description	Note
1.	610135	2	Paper guide, Staple stop	
2.	60597	5	Staple stop finger	
	Not spared	5	Set screw M 4x 16 mm	
3.	611010	1	Stapler stop assembly	
4.	60593	1	Idler roller	

